

**Heritage Square Business Park  
Office / Warehouse Combo  
Clermont, Florida 34715**



**Starting at: \$10.00 / sqft modified gross**

**Specifications**

Address:	355 - 365 Citrus Tower Blvd Clermont, Florida 34715
Zoning:	M-1
Units Available:	750 sqft office
Construction:	Metal
Year Built:	2004 - 2006
Roof:	Metal
Electric:	Progress Energy
Water / Sewer:	City of Clermont
Phone:	Embarq

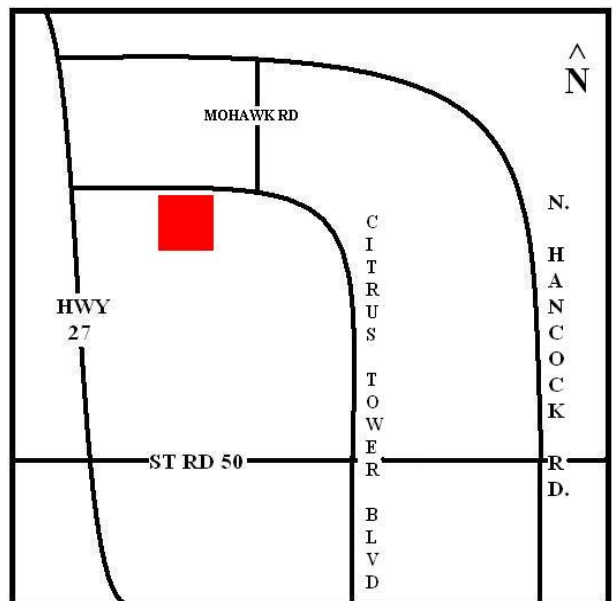

**Prime Central  
Florida Location**

**Call Today for Availability**

[Click here to link to Google Earth for Directions](#)

 HERITAGE SQUARE COMMERCIAL COMPLEX

Located 1/2 mile East of intersection @ Hwy 27 & Citrus Tower Blvd on South side of Citrus Tower Blvd

Attractive, well maintained & managed

Anchor Tenants - Sherwin Williams & Land of Lakes Montessorri School

**One (1) 750 square foot office unit currently available**

**Storefront unit has one separate office and handicap bathroom**

**Extremely competitive rates**

Ample parking

Unit fronts highly travelled Citrus Tower Blvd



**Presco Real Estate Group, LLC**

**Contact: Steve Barr**

**Office: 352.242.0073 x213**

**Fax: 352.242.1960**

**Email:**

[\*\*Steve.Barr@PrescoGroup.com\*\*](mailto:Steve.Barr@PrescoGroup.com)