

CLERMONT COMMONS BUSINESS PARK

Office / Warehouse Combination

Clermont, Florida 34715



Starting at: \$4.00 per Square Foot NNN

Specifications

Address: 230 Mohawk Road
Clermont, Florida 34715
Zoning: M-1
Building Size: Up to 30,000 Square Feet
Space Available: 1,250 - 12,000 Square Feet
Construction: Concrete Block & Metal Framed
Year Built: 1995 and Later
Roof: Flat Metal Roof
Electric: SECO
Water / Sewer: City of Clermont
Phone: Embarq

**Prime Central
Florida Location**

Call Today for Availability

[Click here to link to Google Earth for Directions](#)

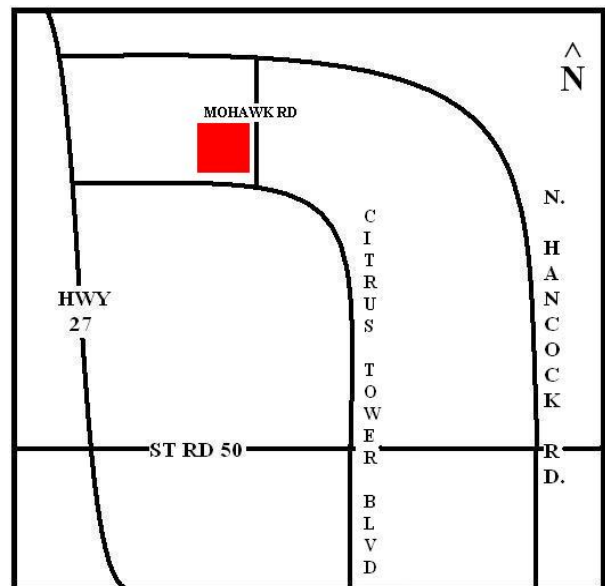

 CLERMONT COMMONS BUSINESS PARK

Located in Clermont 1/2 mile east of the Citrus Tower at the corner of Citrus Tower Blvd & Mohawk Rd.

Ideal for light industrial, manufacturing, warehousing / distribution

Units range from 1,250 - 12,000 square feet

Dock high available

Some buildings fully sprinkled

Small office with a/c & handicap restroom provided in each unit

Extremely competitive rates - Motivated owner willing to make a deal

Convenient access to Highway 27, Route 50 & the Florida Turnpike



PRESCO
REAL ESTATE GROUP
THE DEVELOPMENT SOLUTION COMPANY

Presco Real Estate Group, LLC

Contact: Steve Barr

Office: 352.242.0073 x213

Fax: 352.242.1960

Email:

Steve.Barr@PrescoGroup.com