

CLERMONT COMMONS BUSINESS PARK

Professional Office
Clermont, Florida 34715



Starting at: \$7.00 per Square Foot NNN

Specifications

Address:	230 Mohawk Road Clermont, Florida 34715
Zoning:	M-1
Building Size:	Up to 12,300 Square Feet
Offices Available:	From 1,025 Square Feet
Construction:	Concrete Block & Metal Frame
Year Built:	1995 and Later
Roof:	Shingle / Metal Roof
Electric:	SECO
Water / Sewer:	City of Clermont
Phone:	Embarq

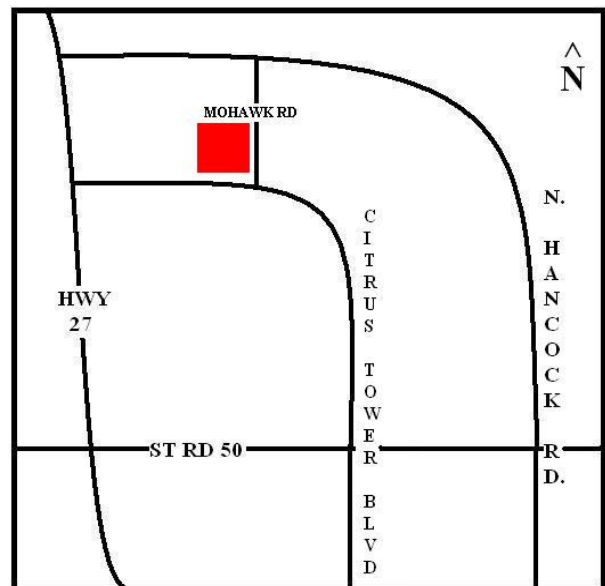

**Prime Central
Florida Location**

Call Today for Availability

[Click here to link to Google Earth for Directions](#)

Located in Clermont 1/2 mile east of the Citrus Tower at the corner of Citrus Tower Blvd & Mohawk Rd.

Professional office with a/c starting at 1,025 square feet

Ample parking available

Handicap restroom in each unit

Convenient access to Highway 27, Route 50 & the Florida Turnpike

Extremely competitive rates - Motivated owner willing to make a deal

Onsite friendly management

One (1) year term leases available



Presco Real Estate Group, LLC

Contact: Steve Barr

Office: 352.242.0073 x213

Fax: 352.242.1960

Email:

Steve.Barr@PrescoGroup.com